

Lay out for wood cutting 2 ft by 4 ft Sheet $\frac{1}{4}$ " thick.
 This is not to scale; Do not enlarge and use.

↑
 Long grain
 of the plywood
 ↓

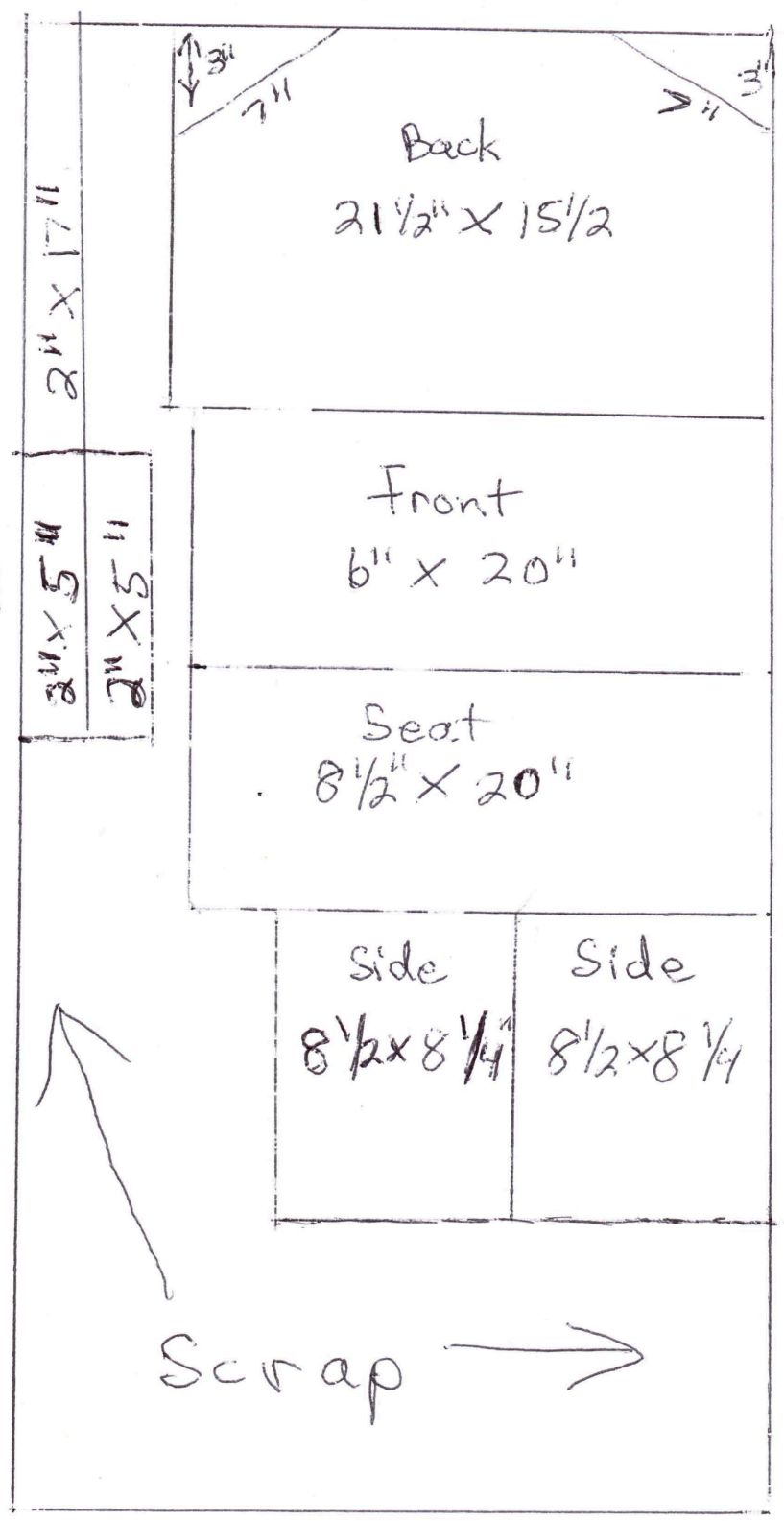

← cut off to
 make top
 Curve.

And
 4 cuts of
 1x1 Square
 Dowel
 6" long each

All measurements
 in inches.

Sewing
 Box
 Designs

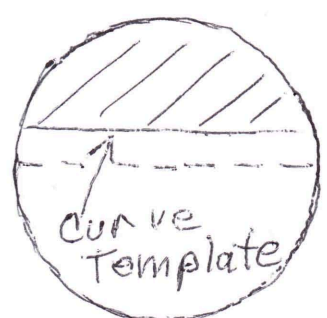

To make the templates for the curved cut outs, make
 a 6" and 8" diameter circle. Fold in half, then mark
 1 inch up. Center the smaller template on side, the larger
 is for the back and front.